

Installation Instructions: Batten Mount 1W Emergency Pack For Battens Open Area Lens 09129

Date	Revision
29.4.24	1

Read these instructions before installation and retain for future reference This equipment should be installed by a competent electrician



Important Information

We recommend that luminaires are installed by a qualified electrician ensuring the installation complies with current IEE wiring regulations BS7671:2018 & local building control..

- BELL will not accept responsibility for any claims arising from a poor installation.
- Do not cover with any insulation.
- Internal use only.

This product may contain substances that can be hazardous to the environment if not disposed of properly. Electrical and electronic equipment should never be disposed of with general household waste but must be separated for its correct treatment and recovery.

Where possible recycle your packaging.



The emergency function test must be performed when a battery is fully charged over 16 /24hours

Dimensions (mm)

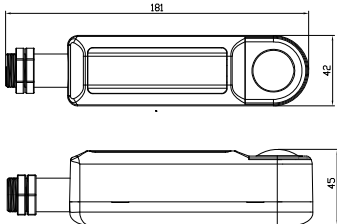

Connections



- Step 1: Plug the battery into the product
- Step 2: Close the battery hatch cover plate

Battery Replacement

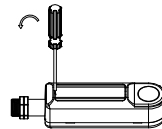

- Step 1: Use a screwdriver to pry open the battery hatch cover plate
- Step 2: Take out the battery

Fitting/Installation

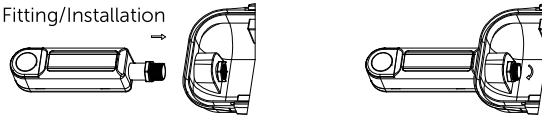

- Step 1: Insert the product into the M20 interface of the three proof lamp, and the waterproof gasket is attached to the three proof lamp.
- Step 2: Screw the M20 nut into the thread from the three proof lamp and tighten the product.

Connections

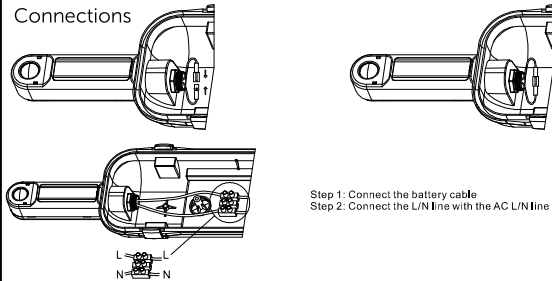

- Step 1: Connect the battery cable
- Step 2: Connect the L/N line with the AC L/N line inside the tri-proof light

Ensure correct polarity of the battery

The drawing in the fitting may vary to the actual product, connect as per label on fitting.

Test button is on the side of the unit under the arrows, opposite side to the indicator LED.

Features

Supply Voltage:220-240VAC 50/60Hz Insulation Class: II
Ingress Protection:IP65
Battery Recharge Time: 24h
Max Battery Temperature: 60°C
Ambient Temperature:0-45°C
Charge indicator: Dual colour LED
Deep Discharge Protection DDP Assembly indoors to flat surface Non-maintained Operation
The lamp holder shall not be replaced

Important

It is recommended that the unit is installed by a competent person ensuring the installation complies with the necessary standards.

The company accept no responsibility for incorrect installation, operation or maintenance.

After installation of the fitting, the battery must be charged for 16/24 hours.

The battery should be changed when the battery be failed on charging's ability.

The LED's module from the light is non-replaceable.

Building insulation may abut the sides of the luminaire.

Indicator LED System status is locally by a bi-color indicator LED.

LED Indication	Status	Description	
Permanent Green	Standby ,System OK	Mains Operation, battery is charged	NOTICE Fault status: If an error is detected, the indicator L switches to RED. If the error has been corrected please re-connecting the bi after the mains power off, the indicat immediately switches back to GREEN mains power on.
Fast flashing Green (0.25s on 0.25s off)	Function test underway	Function test underway	
Slow flashing Green (1s on 1s off)	Duration test underway	Duration test underway	
Permanent Red	Lamp failure	Open Circuit or Short circuit or LED failure	NOTICE Battery failed duration test: After an exchange of the battery and down the button (>10S) reset the time indicator LED switches to GREEN.
Fast flashing Red (0.25s on 0.25s off)	Battery capacity failure	Battery failed duration test	
Slow flashing Red (1s on 1s off)	Battery fault	Incorrect battery voltage or Open Circuit	
Green and Red off	Battery Operation	Emergency mode: Mains disconnected or Mains failure	
LED flashing and indicator light (green light) flashing at the same time	Battery connection failure	Reverse connection or short circuit of battery	

This product has self test and standard test function.

Press the test button for function test, the green LED will flash for 5 seconds. To activate the programme, long press the test button for 10 seconds.

Long press for 5 seconds to activate mode. Red flash (4 Hz) is for standard function, and green flash (4Hz) for self test function.

Technical Helpline +44 (0)1924 893380

www.bellighting.co.uk

British Electric Lamps Ltd
Unit A Foxbridge Way, Normanton Industrial Estate
Normanton, West Yorkshire. WF6 1TN

T: +44 (0)1924 893380 F: +44 (0)1924 894320 E: sales@bellighting.co.uk

www.bellighting.co.uk